

122°30'E

123°E

SHIRE OF BROOME

122°35'4.59"E
18°54'55.03"S

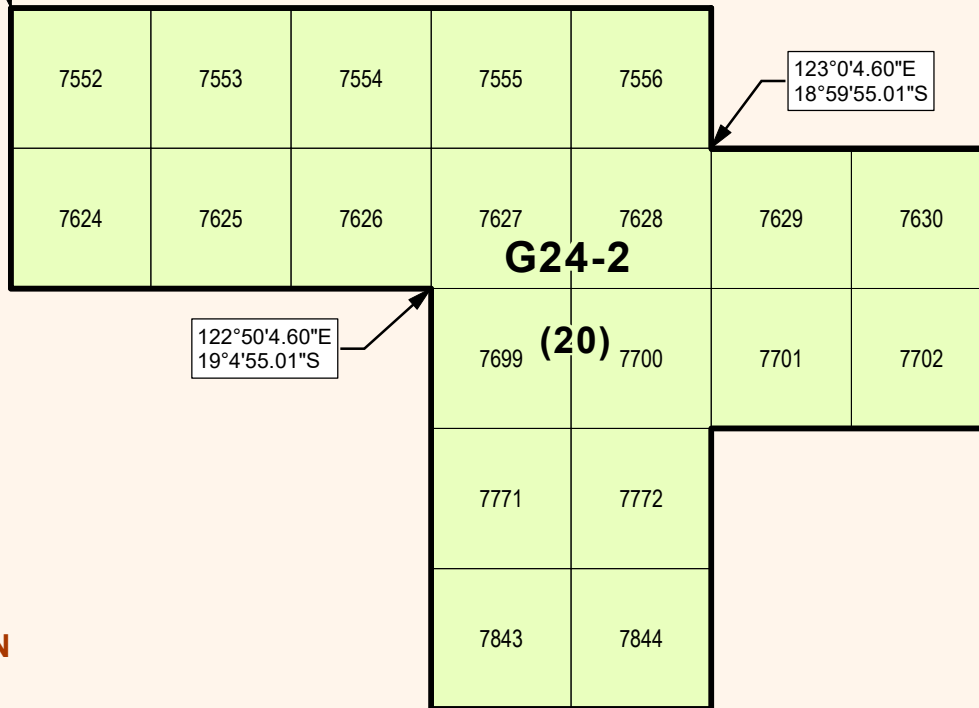

123°0'4.60"E
18°59'55.01"S

Broome Blocks
(SE50)

122°50'4.60"E
19°4'55.01"S

123°10'4.62"E
19°9'55.00"S

CANNING BASIN

123°0'4.62"E
19°19'55.03"S

Department of Energy, Mines,
Industry Regulation and Safety

Geothermal Release Area G24-2

G24-2



Coordinates hereon are in accordance with
Section 8 of the Petroleum and Geothermal Energy Resources Act 1967 (WA) (PGERA67)
The displayed grid defining the 5' x 5' blocks is AGD66 and coordinates shown are GDA94.

